

Bliz 6000 mAh Power Bank w/2-in-1 Cable

Instruction Manual

7121-57

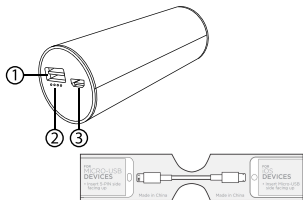

Features:

1. USB Output
2. LED Indicator
3. Micro USB Input

What's included:

- 1 x 6000 mAh Power Bank
- 1 x 2-in-1 charging cable (see above diagram)
- 1 x Instruction Manual

Tech Specifications

- 6000 mAh/5V Lithium-ion battery
- Input power: DC5V/2A
- Output power: DC5V/2.1A

LED Indicators:

- Shows the remaining power capacity.

Battery Indicator	one	two	three	four
Power	<25%	25-50%	50-75%	75-100%

Instructions:

1. Charging the power bank:

- a. Using 2-in-1 charging cable, insert the USB A port into a certified USB AC adapter or USB port of a computer, insert the 2-in-1 tip (the side with pins upwards) into power bank micro input. Then charge begins.
- b. When Charging LED Indicator will flash BLUE, Once fully charged LED will be solid BLUE.

2. Charging mobile phones and other electronic devices:

- a. Connect the 2-in-1 cable to your mobile phone/device. If Android device, the tip with pins upwards; If iOS device, the tip without pins upwards. Connect the other end to the power bank. BLUE LED Indicator will illuminate when charging.
- b. Remove the USB cable from your mobile device when it is fully charged.

** Note: In order to charge devices, use only the accessory cable or the cable included with your own device by the manufacturer.*

SAFETY PRECAUTIONS:

WARNING—When using this product, basic precautions should always be followed, including the following:

1. Read all the instructions before using the product.
2. Charge the power bank fully before initial use. The unit's full performance is achieved only after 2 or 3 completed charge and discharge cycles.
3. To reduce the risk of injury, close

supervision is necessary when the product is used near children.

4. Do not expose the device to moisture.
5. Do not use the device in excess of its output rating. Overload outputs above rating may result in a risk of fire or injury.
6. Do not use the device if damaged or modified.
7. Damaged or modified batteries may exhibit unpredictable behavior resulting in fire, explosion or risk of injury.
8. Do not disassemble the device. Take it to a qualified service person when service or repair is required. Incorrect reassembly may result in a risk of fire or injury.
9. Do not expose the device to fire or excessive temperature. Exposure to fire or temperatures above 212°F may cause explosion.
10. Have servicing performed by a qualified repair person using only identical

FCC Statement:

This device complies with Part 15 of the FCC Rules. Operation is subject to the following two conditions:

- (1) This device may not cause harmful interference, and
- (2) This device must accept any interference received, including interference that may cause undesired operation.

* Warning:

Changes or modifications not expressly approved by the party responsible for compliance could void the user's authority to operate the equipment.